

Številka modela:
2312-864-84

Tip
864

ESENA

1D1W

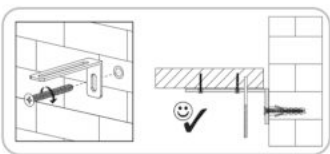
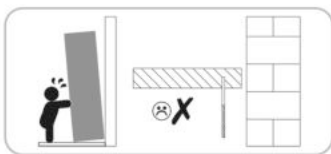
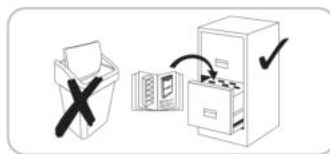
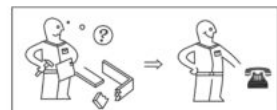
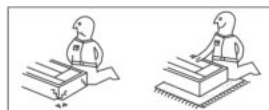
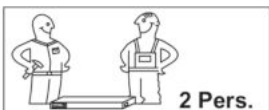

Ø5
Ø8

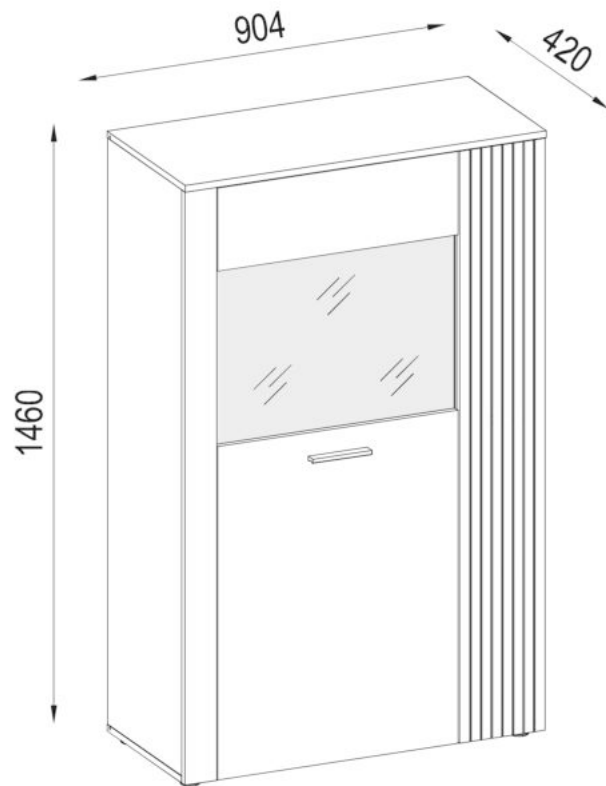
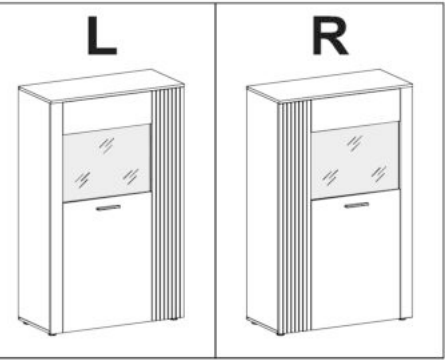

- trdno pritegniti
- vtisniti
- izmeriti
- vtisniti
- beverni
- Otočte - obratite

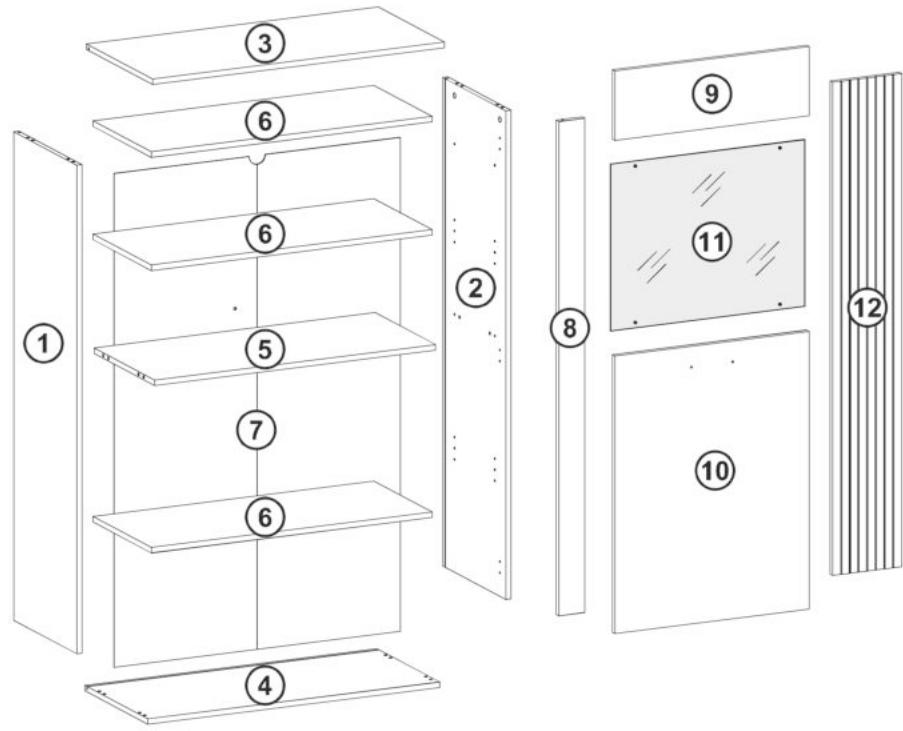

max. 10KG = 4 max. 5KG = 5 6

A	B (mm)		C	D
1	1408	400	16	x1 2/2
2	1408	400	16	x1 2/2
3	904	420	16	x1 1/2
4	904	400	16	x1 1/2
5	870	384	16	x1 1/2
6	870	370	16	x3 1/2
7	1423	886	2,5	x1 2/2

A	B (mm)		C	D
8	1424	80	18	x1 2/2
9	200	604	16	x1 2/2
10	800	604	16	x1 2/2
11	602	481	4	x1 2/2
12	1421	214	16	x1 2/2

B1				1/2
----	--	--	--	-----

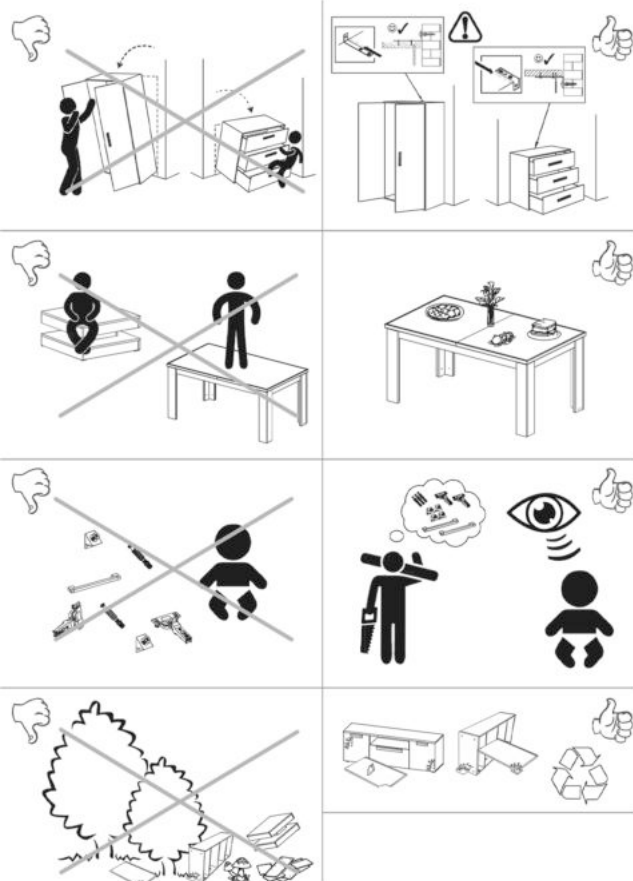

B1 1/2

A1 15x12 x8		C2 44mm x8		B2 8x30 x12	
FA1 4mm x1		F3 6,3x50 x4		O3 Ø18 x4	
K6 Ø35 x3		J65 128/148 x1		O4 Ø18 x4	
M1 10x10x15 x12		P14 45x20 x4		N1 Ø6 x12	
Y36 75x32x15 x1		N5 10x6x10 x4		DB2 4x25 x2	
D25 4x25 x4		Y37 8x50 x1		Y35 4,2x65 x1	
DA21 4,2x16 x18		D11 3,5x16 x14		R10 Ø10 x4	
T1 30x35x55 x3		K9 Ø35 x3		O5 Ø8 x2	
O6 40x40x14 x3					

Spoštovana stranka, zahvaljujemo se vam za nakup pohištva iz našega notranjega programa za izključno uporabo v zasebnih prostorih. Prosimo, da preverite popolnost obsega dobave in pred namestitvijo natančno preberete naslednje pomembne informacije ter jih shranite za poznejšo uporabo, tudi s strani tretjih oseb. Naše pohištvo je treba uporabljati v skladu s predpisi. Uporaba v nasprotju s predpisi lahko povzroči materialno škodo in v določenih okoliščinah tudi telesne poškodbe. Pohištvo ni igrača. Proizvajalec ali prodajalec ne prevzemata jamstva za škodo, ki nastane zaradi uporabe v nasprotju s predpisi ali nepravilnega ravnanja.

OPOZORILO: Otroci ali osebe z motnjami v duševnem razvoju se morajo ves čas izogibati delom pohištva, koničastim predmetom, majhnim delom in embalaži, saj obstaja nevarnost poškodb in/ali zadužitve.

MONTAŽA: Pri sestavljanju upoštevajte naša navodila za uporabo, delovanje, namestitvev ali montažo ter bodite posebej pozorni na opozorila in varnostna navodila. Neupoštevanje navodil lahko povzroči telesne poškodbe ali poškodbe pohištva/varnostne nevarnosti. Če imate kakršne koli težave pri namestitvi/montaži, se obrnite na našo servisno službo. Z veseljem vam bodo svetovali in pomagali. Namestitev lahko opravi le usposobljeno osebe. Ne prevzemamo nobene odgovornosti za škodo, če so na izdelku/delu/delah izdelka opravljene spremembe ali če so zamenjani ali uporabljeni deli/potrošni material, ki ne izvirajo od proizvajalca/prodajalca. Če so z blagom dobavljeni stenski pritrdilni elementi, kot so zatiči in vijaki, so ti namenjeni samo za uporabo na stenah iz trdnih in homogenih materialov. Pritrditev je tako dobra kot povezava med pritrditvijo in steno. Pred pritrditvijo morate preveriti primernost stene za stoječe in viseče pohištvo ter uporabiti le primerne pritrdilne elemente. Pred vsakim nameščanjem se prepričajte, da v prostoru za dobrodošlico ni električnih žic. Na koncu je za pritrditev stene odgovoren monter.

To velja tudi za vgradnjo električnih izdelkov in drugih gradbeno-tehničnih pripomočkov. Montažo/vgradnjo električnih izdelkov in drugih pomembnih gradbeno-tehničnih pripomočkov lahko izvaja le pooblaščen usposobljen osebe. Vse električne in gradbeno-tehnične inštalacije morajo biti izvedene v skladu z veljavnimi standardi in varnostnimi predpisi v vaši državi. Pri svetlobnih virih uporabljajte le dovoljeno jakost osvetlitve. Neupoštevanje največjega števila vatov lahko povzroči nevarnost požara zaradi pregrevanja. Zaradi nevarnosti požara prekrivanje svetilk ni dovoljeno. Popolno delovanje pohištva je zagotovljeno le pri navpični in vodoravni namestitvi. Vrata so vnaprej nastavljena, vendar jih je mogoče glede na lokalne razmere ponovno nastaviti. Upoštevajte podatke o teži za največjo obremenitev. Na pohištvo se ne sme plezati. Ob nestrokovni uporabi se lahko pohištvo prevrne. Da bi to preprečili, je treba pohištvo vedno zavarovati pred prevrnitvijo. Pri preobremenitvi/preveliki obremenitvi (zlasti zaradi igranja otrok, ljudi, materialov ali drugih neprimeren vplivov) obstaja nevarnost zloma in poškodb. Vse vijake in podporne priključne točke je treba po 5 do 6 tednih zategniti, da se zagotovi trajna stabilnost.



SKRB ZA POHIŠTVO—Da bi v našem izdelku uživali čim dlje, upoštevajte naša navodila za pravilno nego pohištva. Pri čiščenju uporabljajte čisto, suho in mehko bombažno krpo. Če pohištvo potrebuje temeljito čiščenje, lahko krpo navlažite z malo vode ali čistilom za pohištvo in nato očiščene dele posušite. Kovinske in steklene dele je najbolje očistiti s komercialno dostopnimi čistili za kovine in steklo v skladu z navodili na izdelku. Na čistilih mora biti jasno navedeno, da so primerna za čiščenje pohištva. Nikakor ne uporabljajte parnih čistil, kavstičnih sredstev, abrazivnih sredstev ali drugih izdelkov, katerih učinkov ne poznate. **POZOR:** Površine z visokim sijajem so ob dobavi zaščitene z zaščitno folijo. Folijo pustite na pohištvu, dokler ni popolnoma sestavljeno in očiščeno prahu. Predmete z visokim sijajem, s katerih je bila odstranjena zaščitna folija, lahko očistite in uporabite šele po 72 urah (čas za naknadno strjevanje na zunanjem zraku). Površin ne smete poškodovati z ostrimi predmeti in jih nikoli ne smete izpostavljati močni sončni svetlobi.

LIKVIDACIJA— Navodila za odstranjevanje odpadkov —

Za zaščito okolja odpadno embalažo odlagajte ločeno po vrstah v za to namenjene smetnjake/koše za recikliranje in je v nobenem primeru ne odlagajte v okolje. Poškodovano ali neuporabno pohištvo lahko pošljete v posebne zbirne centre za recikliranje posameznih delov. Rabljenega, a še vedno funkcionalnega pohištva ni treba takoj odstraniti. Podarite ga na primer dobrodelnim organizacijam. Želimo vam veliko veselja z novim pohištvom.

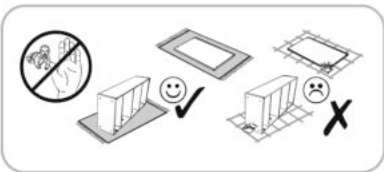
1



- A1** 15x12  x4
- C2** 44mm  x4
- B2** 8x30  x8

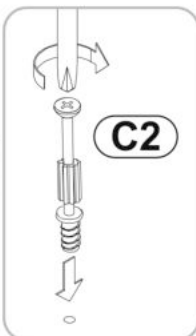
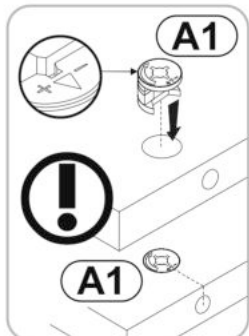
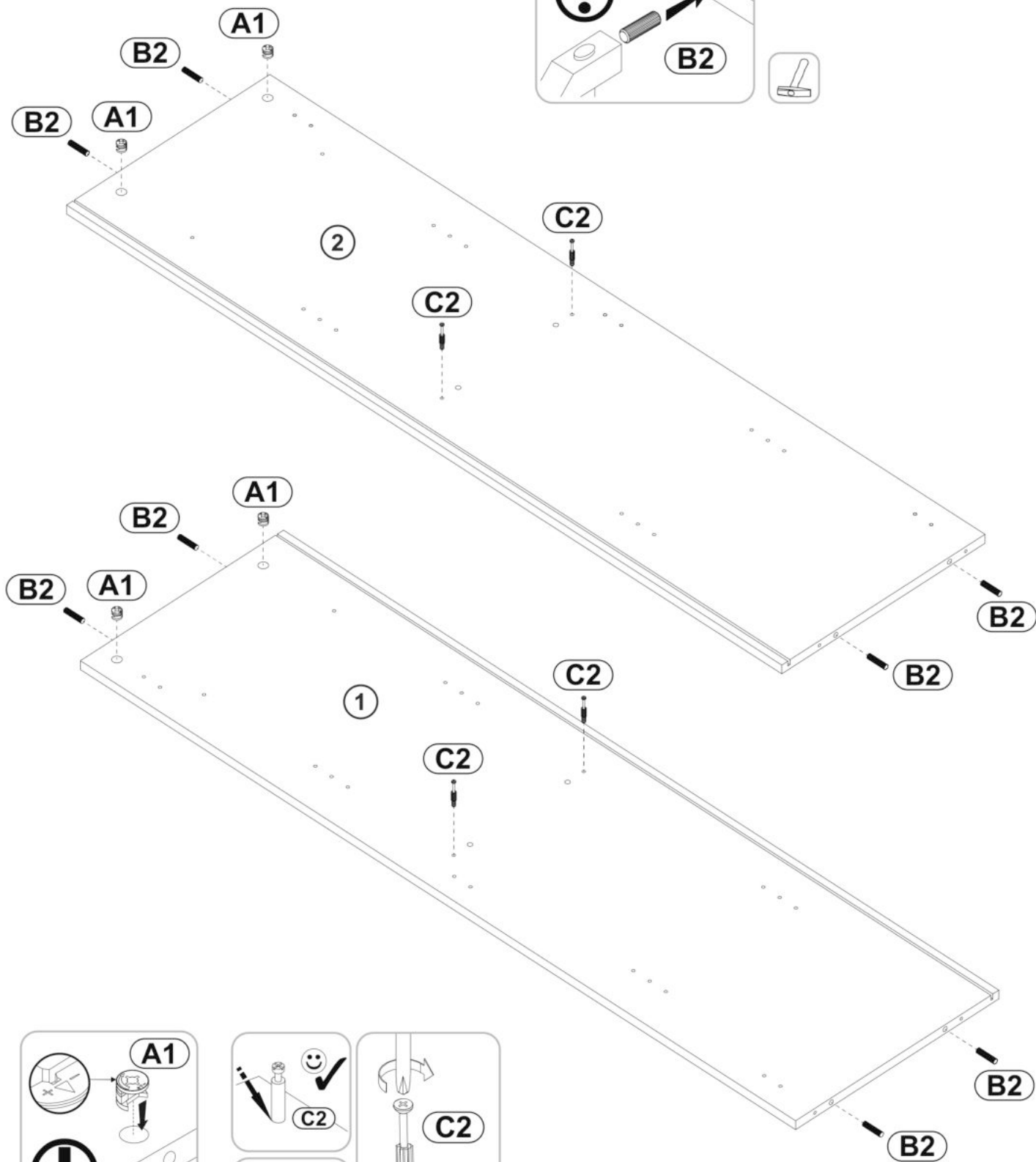
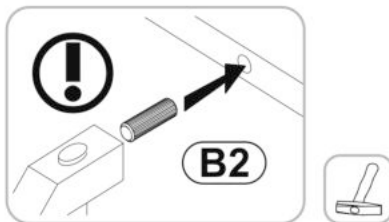

2

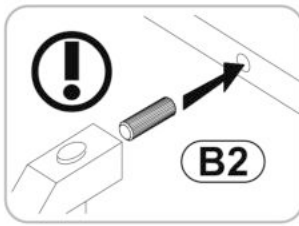
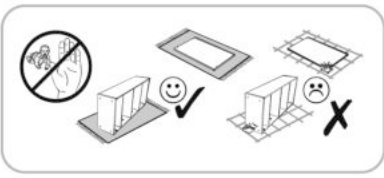

A1		x4
15x12		
C2		x4
44mm		
B2		x4
8x30		
Y36		x1
75x32x15		
D11		x2
3,5x16		

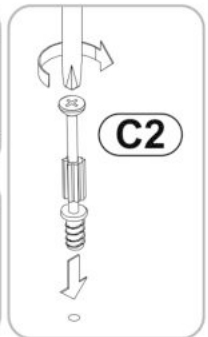
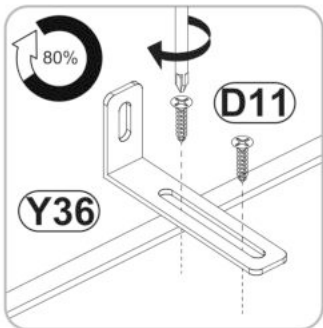
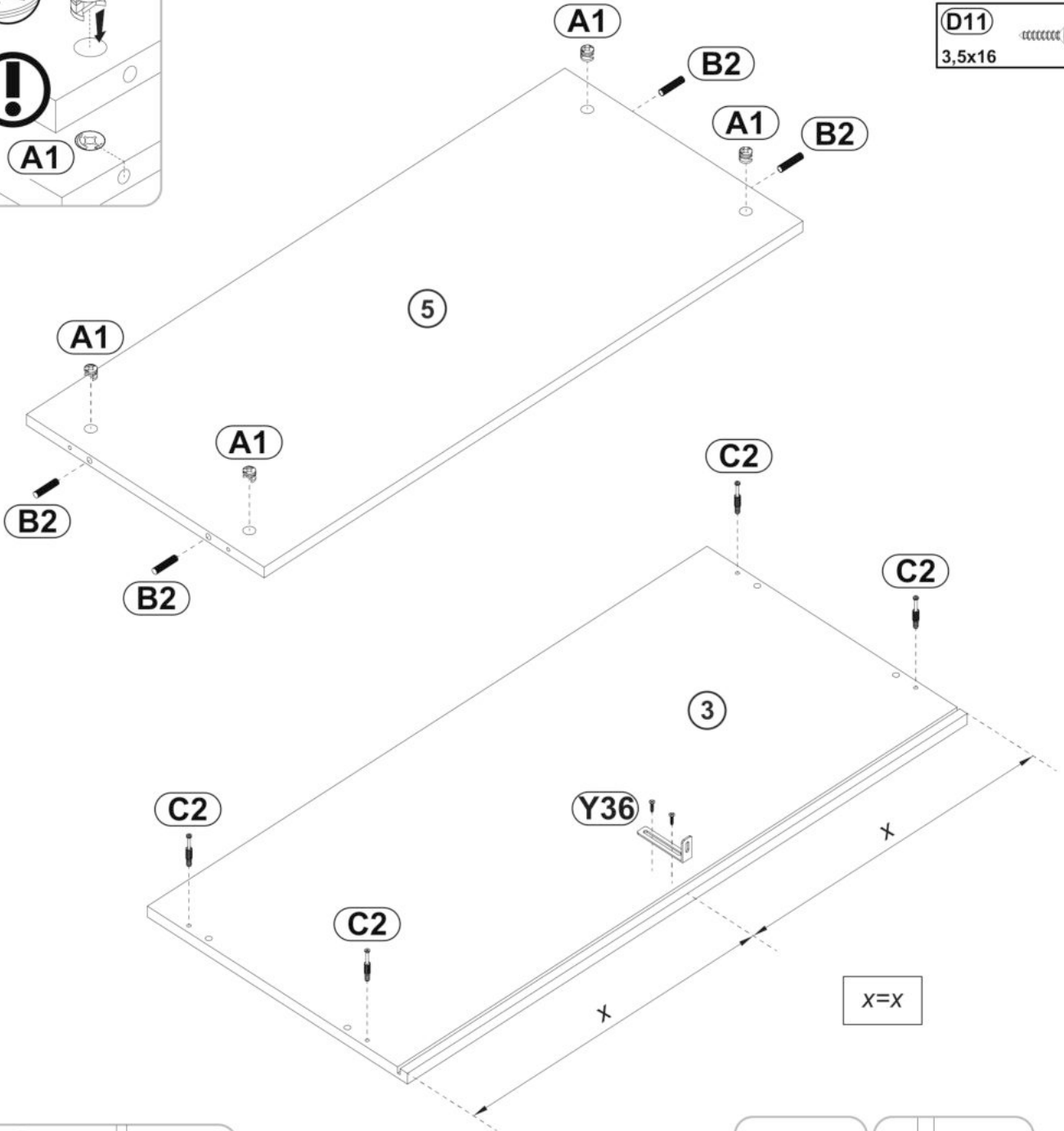
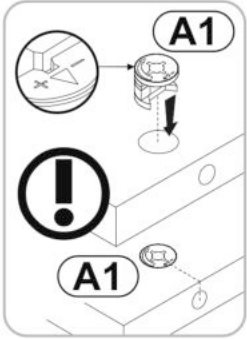

3

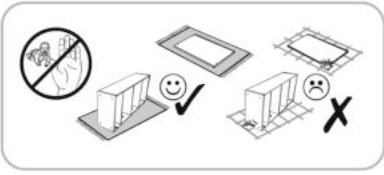

DA21
4,2x16  x6

T1
30x35x55  x3

K9
Ø35  x3

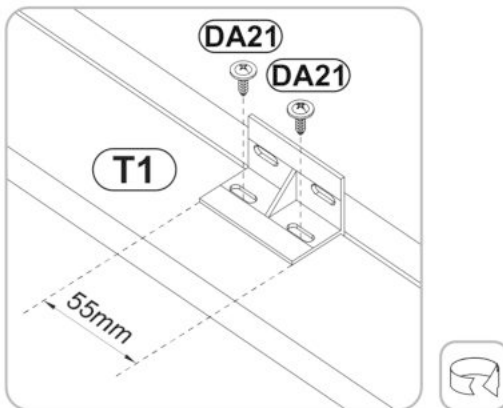
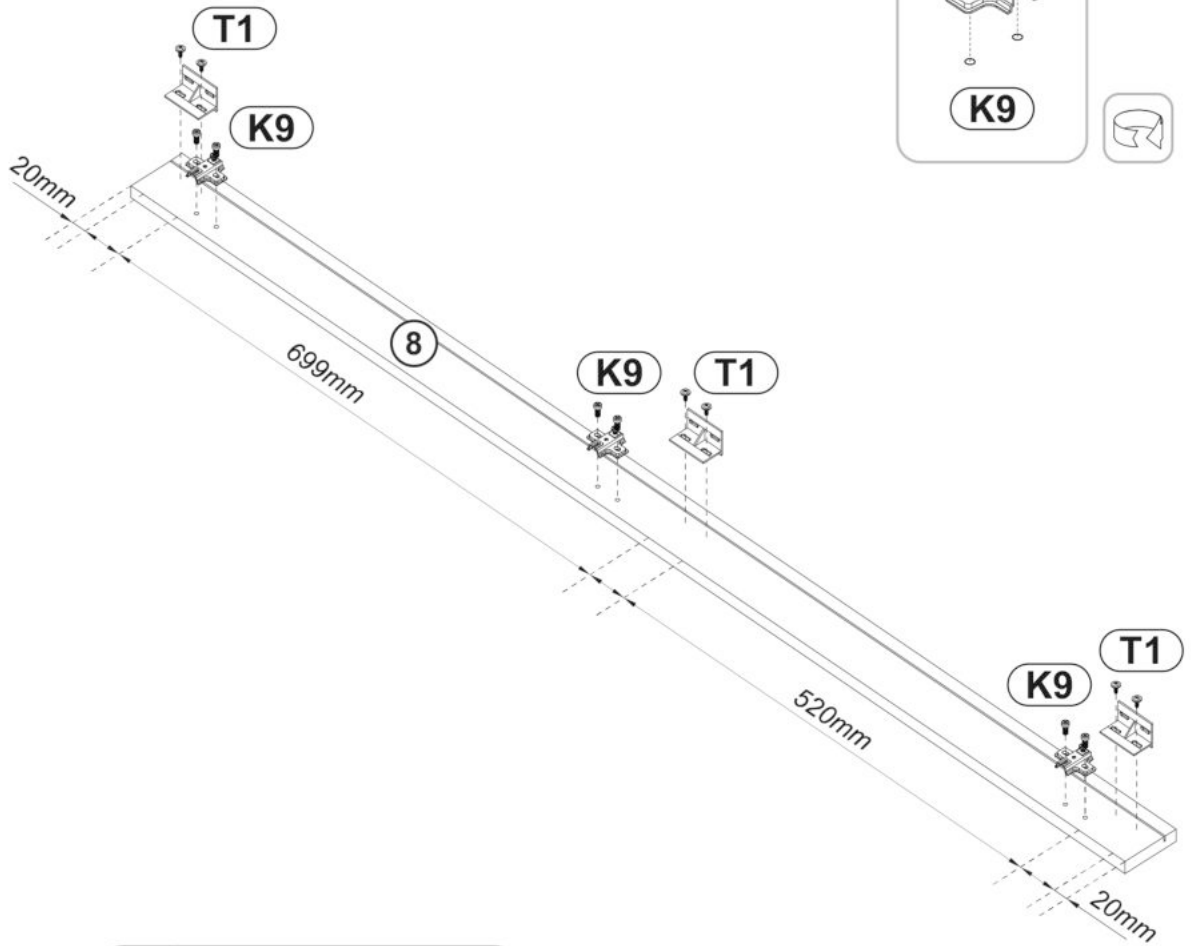
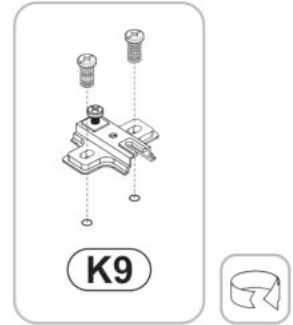
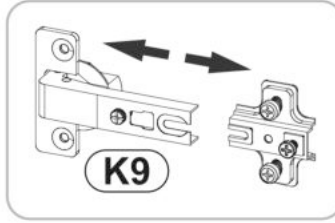

4

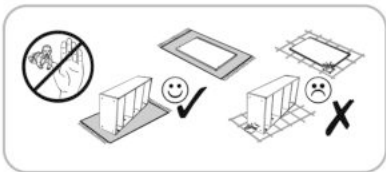

O3  **x4**
Ø18

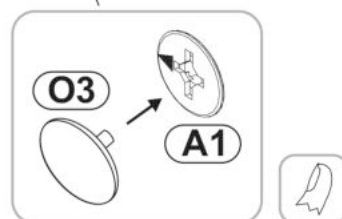
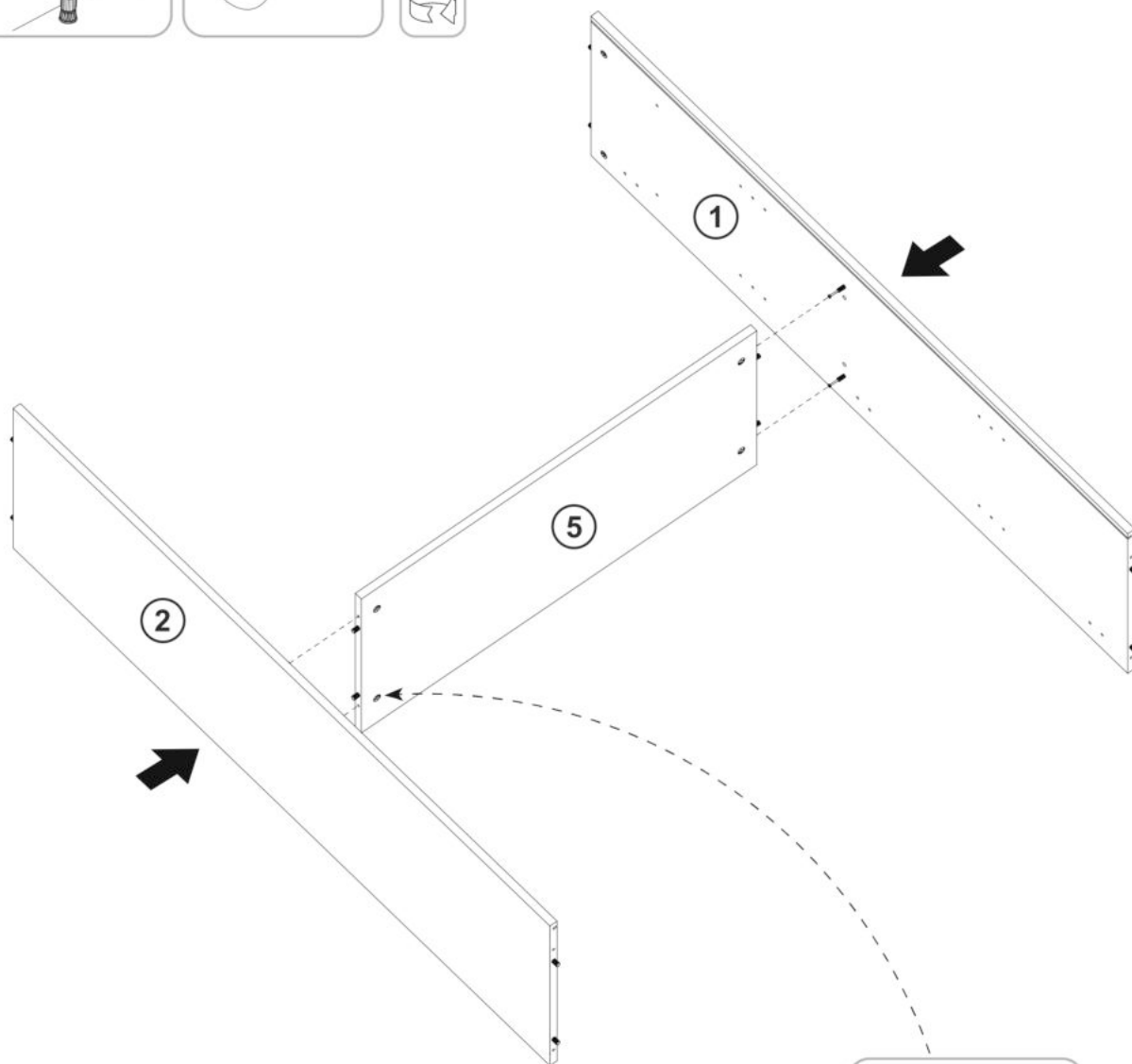
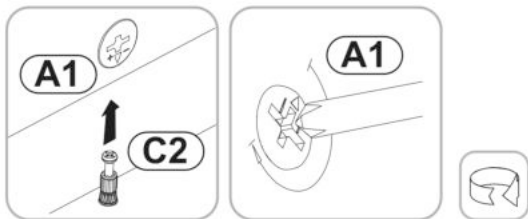

5

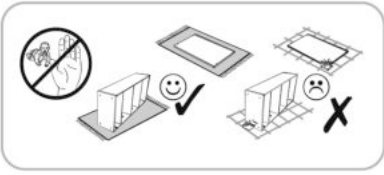

O4
Ø18 x4

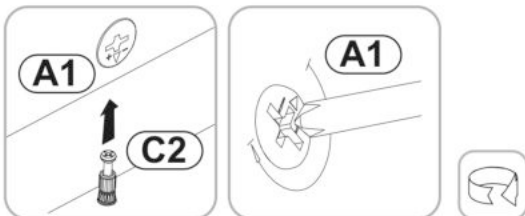
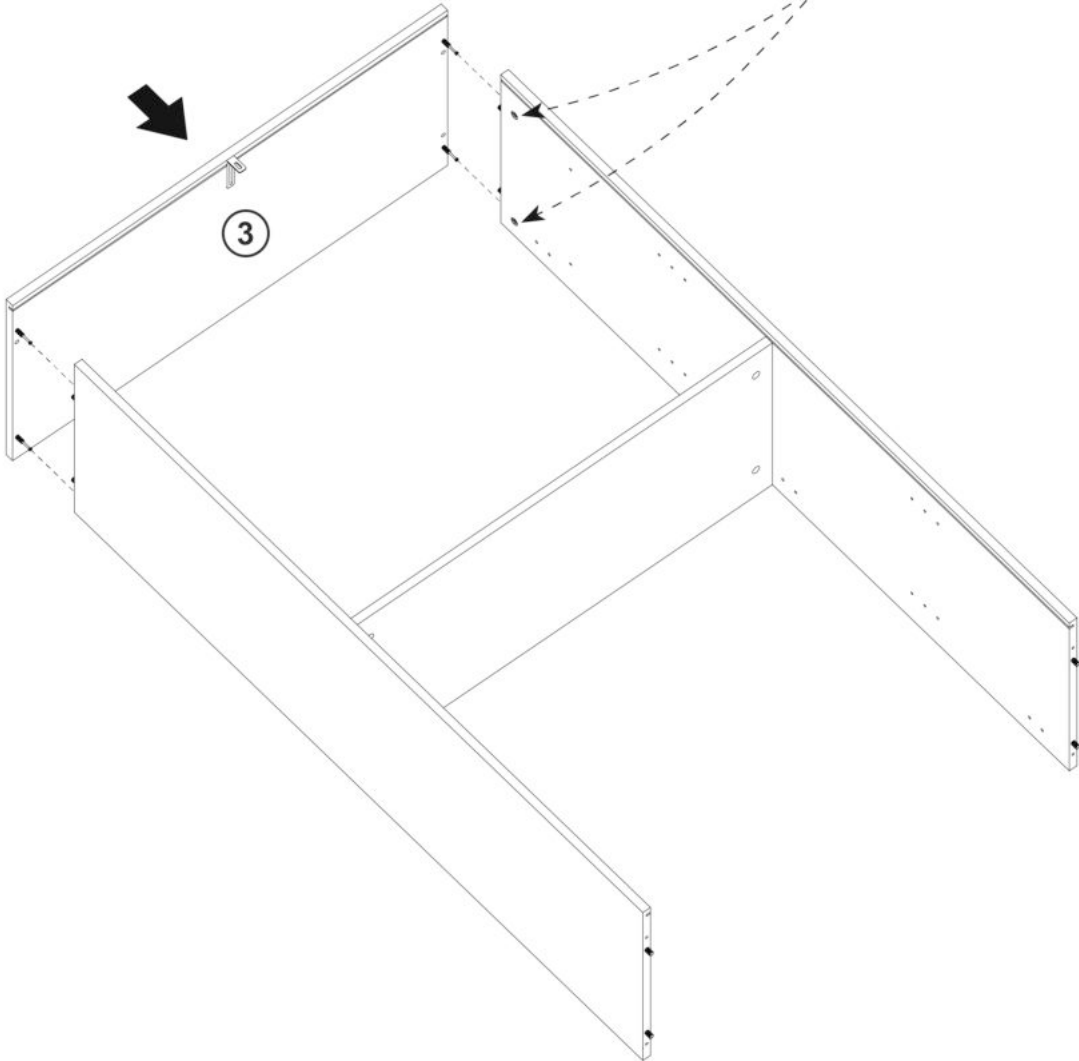
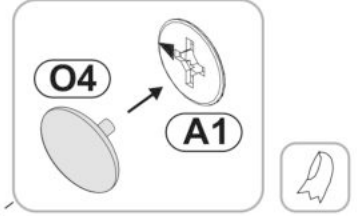

6

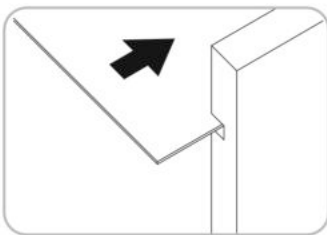
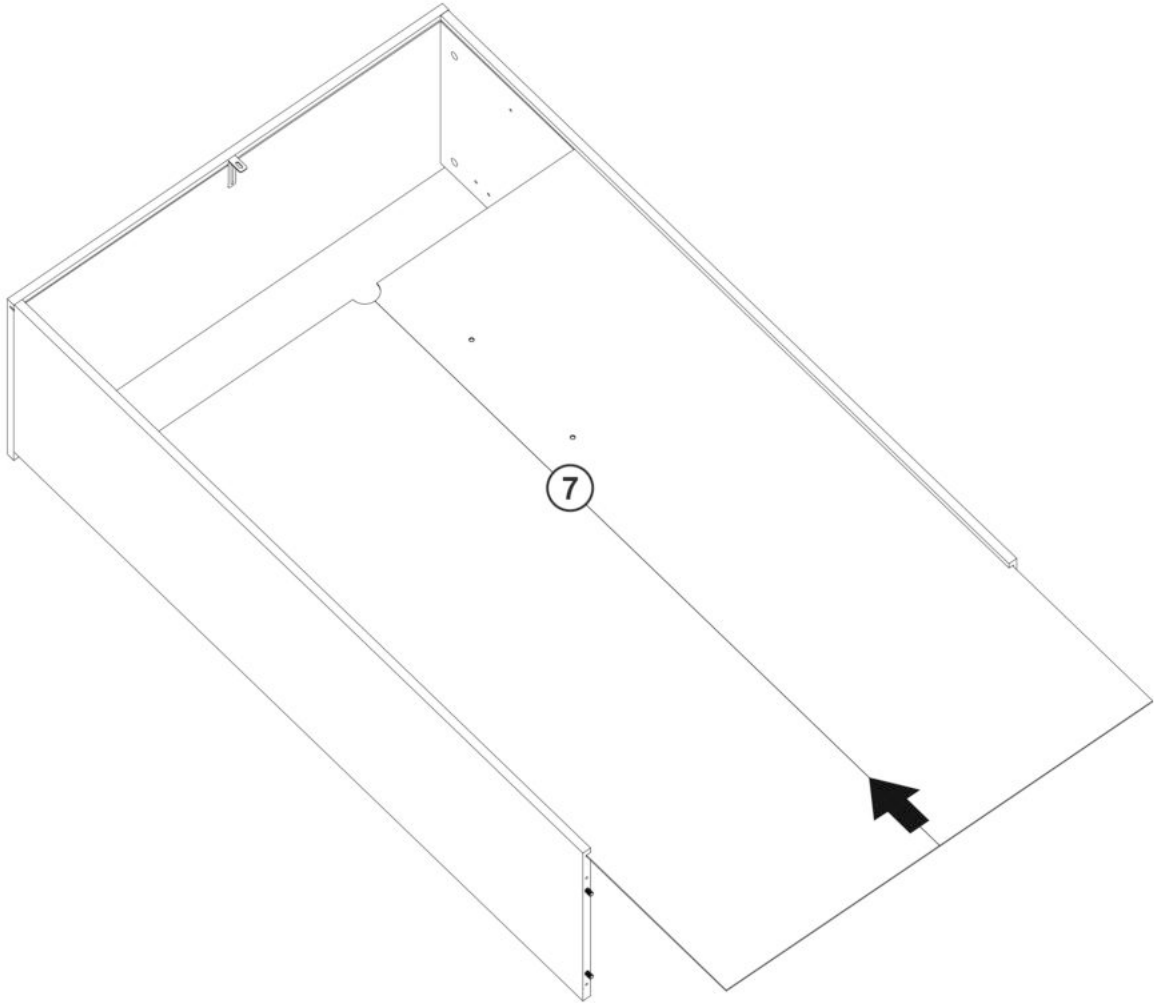
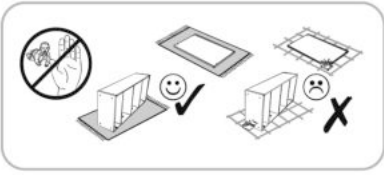

7

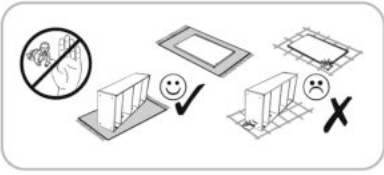

FA1
4mm x1

F3
6,3x50 x4

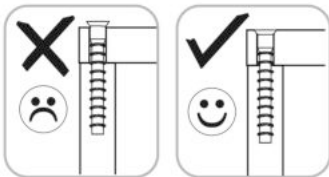
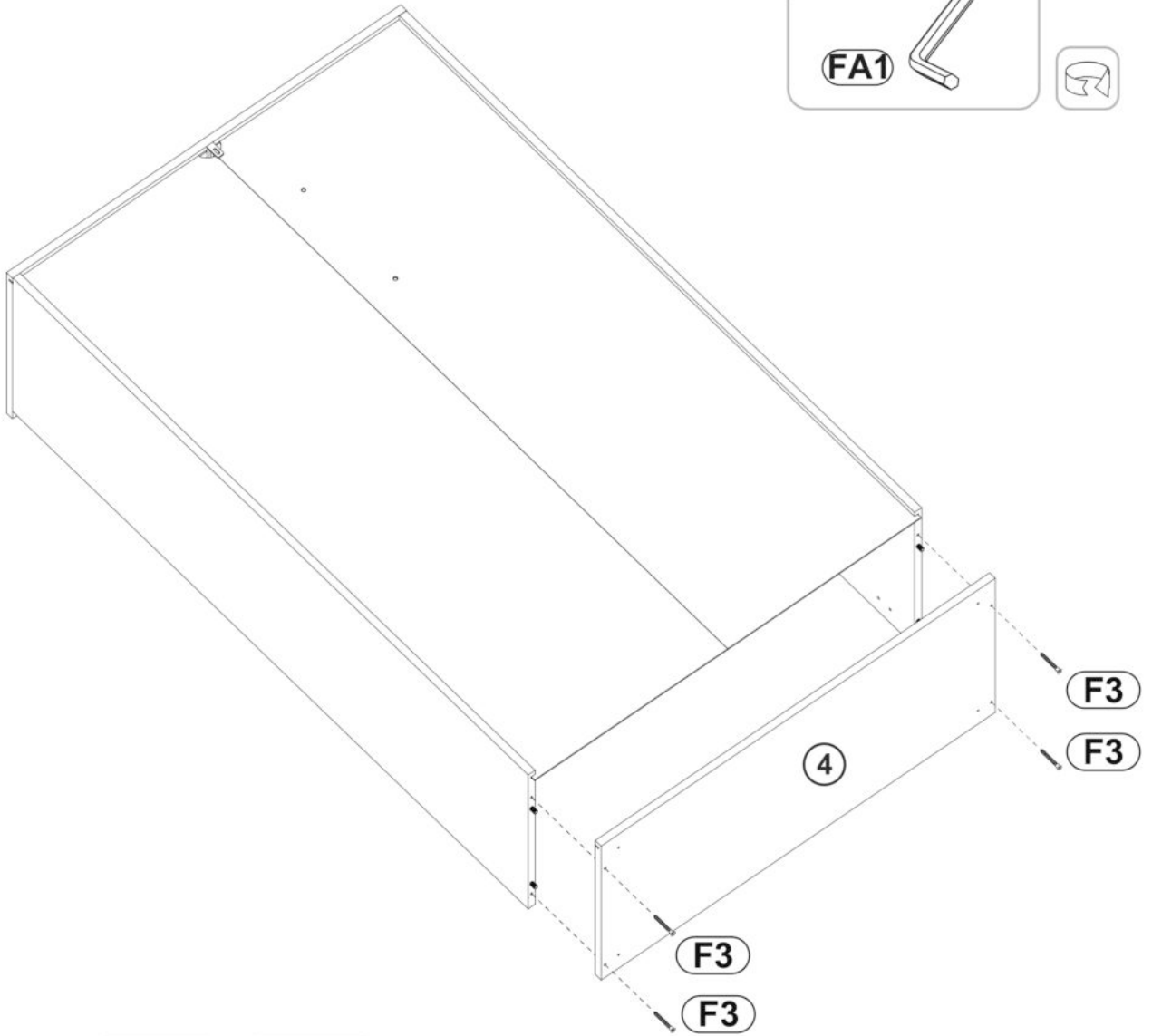
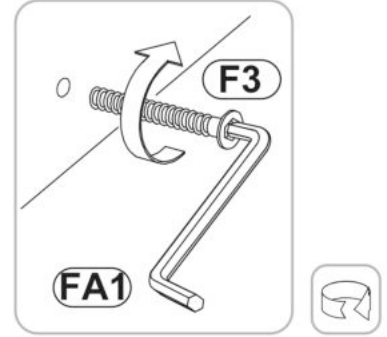

8

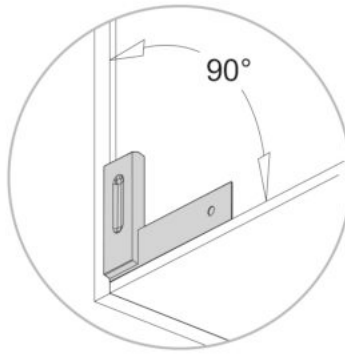
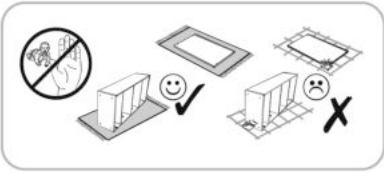

A=B

M1
10x10x15 x12

DA21
4,2x16 x2

P14
45x20 x4

D25
4x25 x4

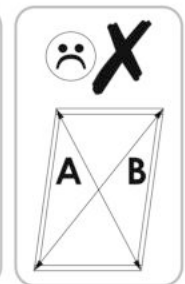
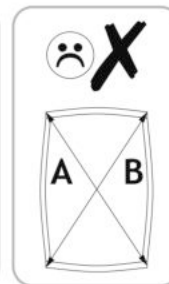
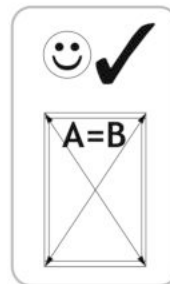
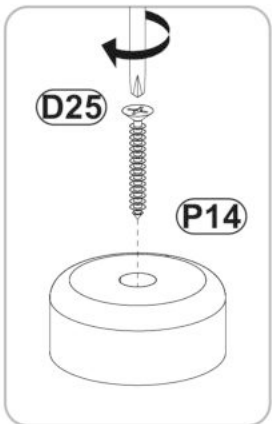
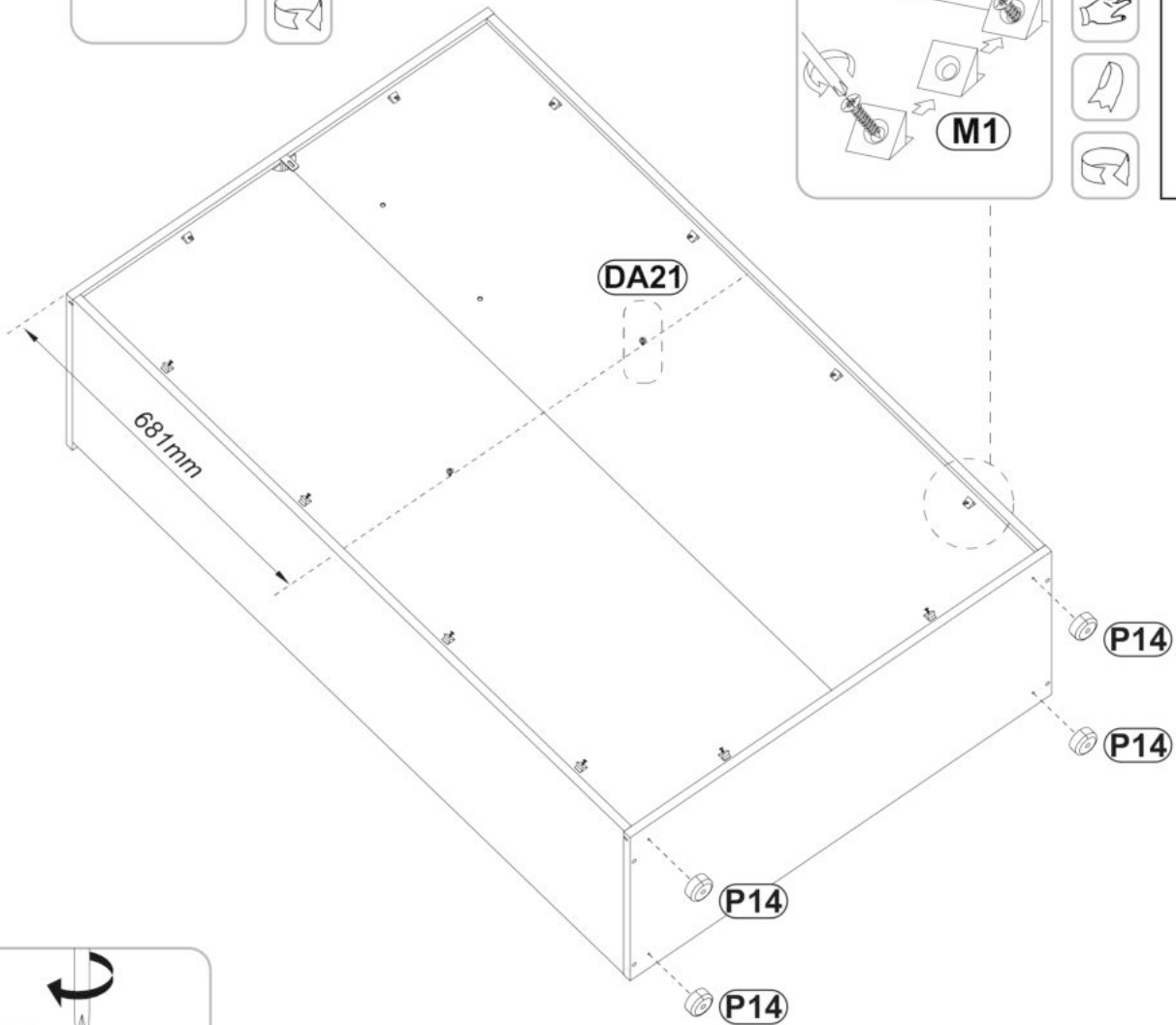
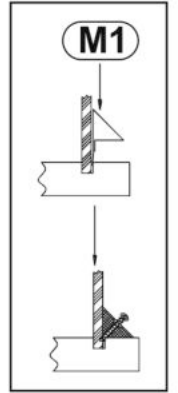
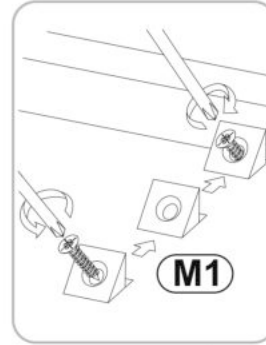
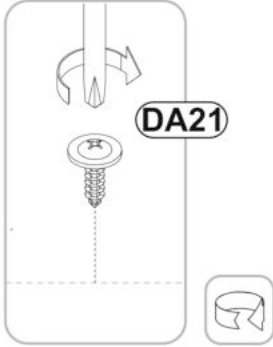

9

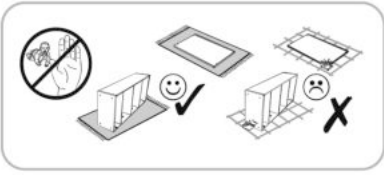

N1  **x12**
Ø6

O5  **x2**
Ø8

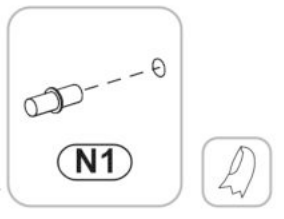
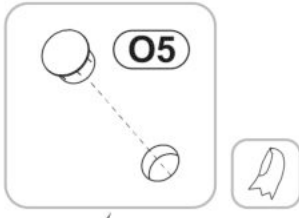
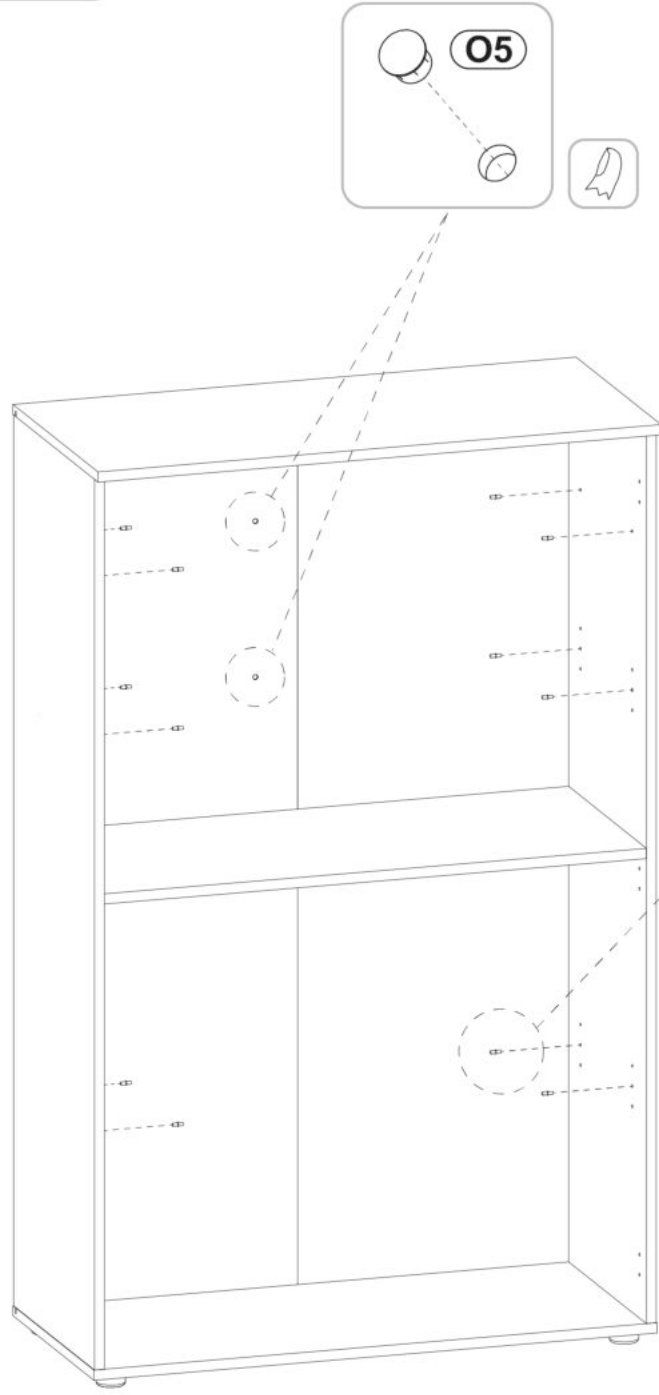

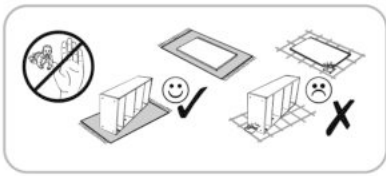

Y37
8x50  x1

Y35
4,2x65  x1

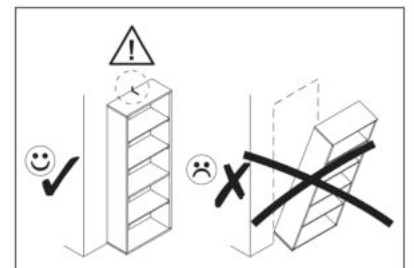
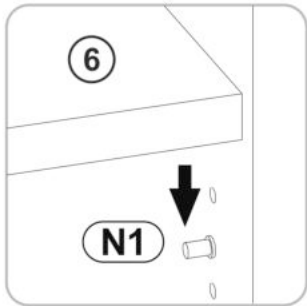
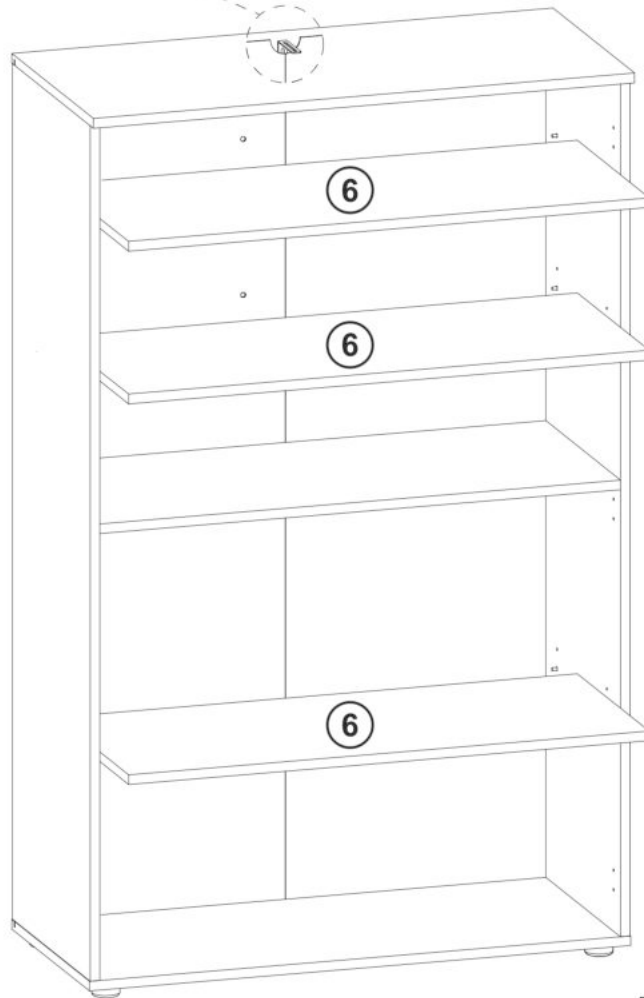
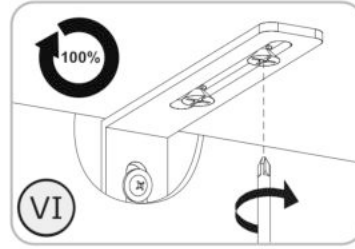
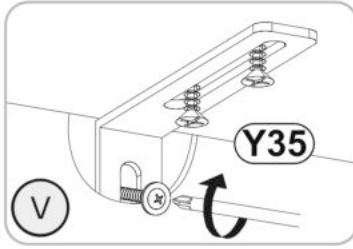
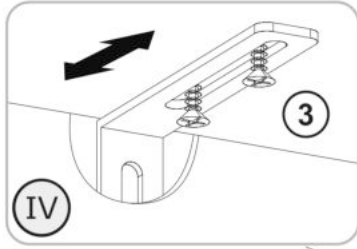
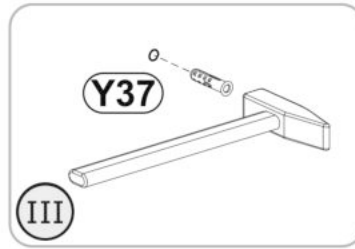
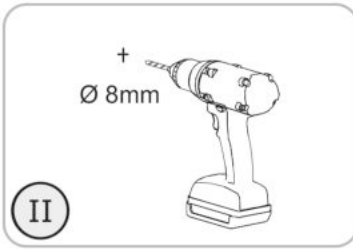
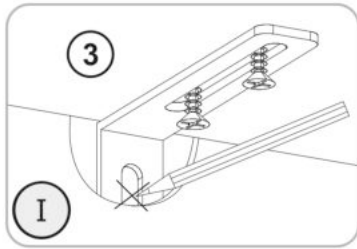

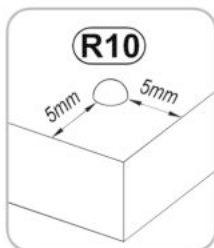
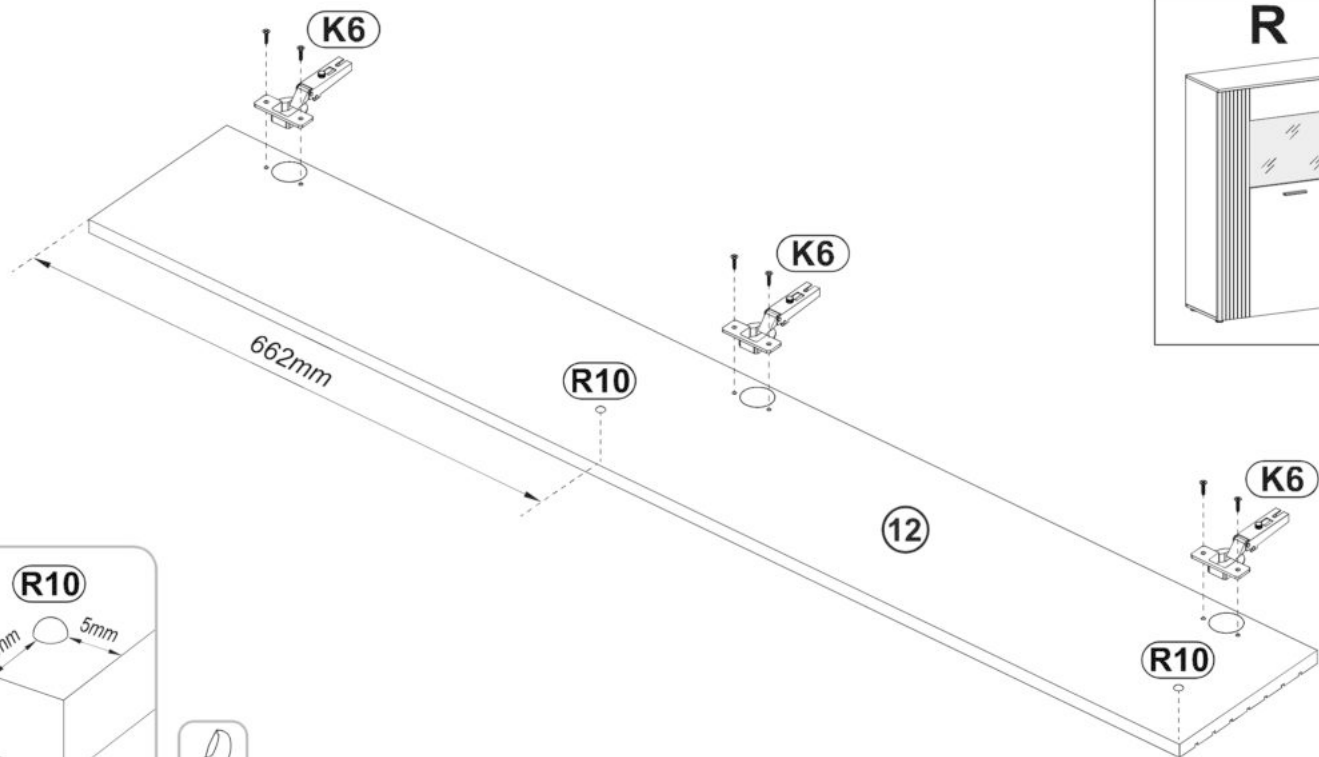
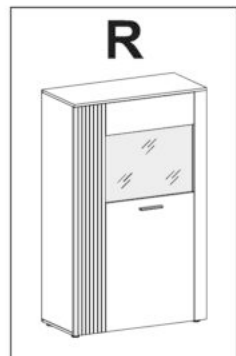
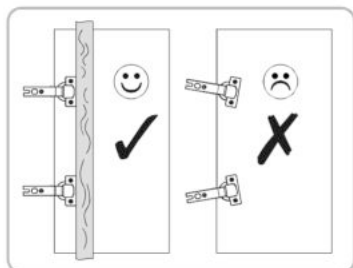
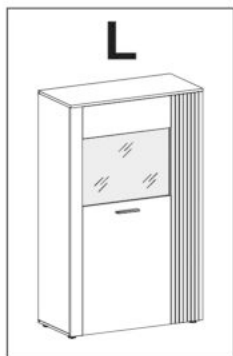
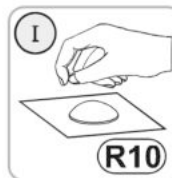
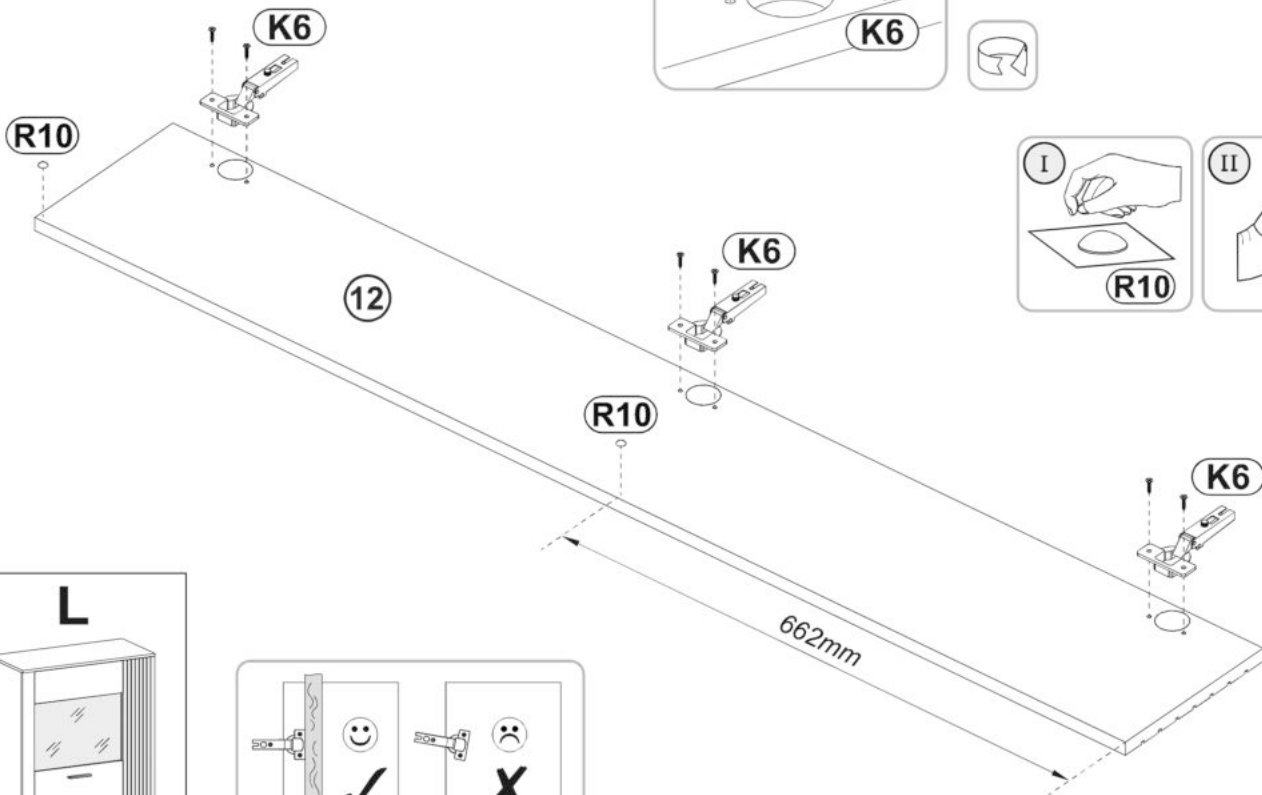
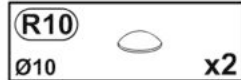
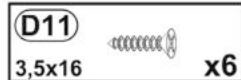
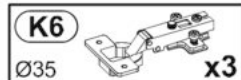
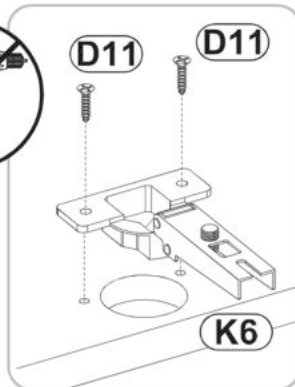
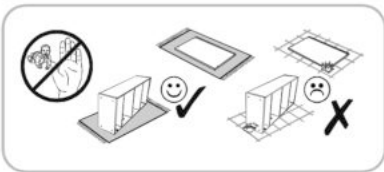

12

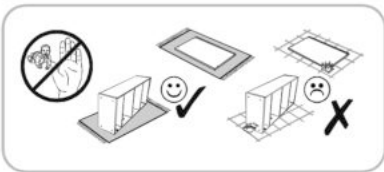

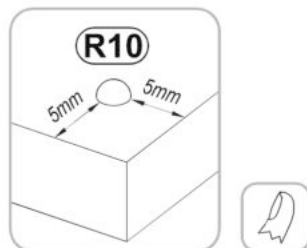
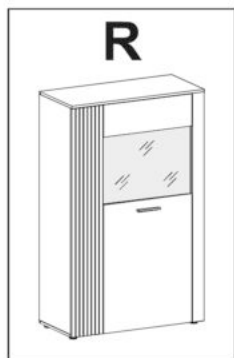
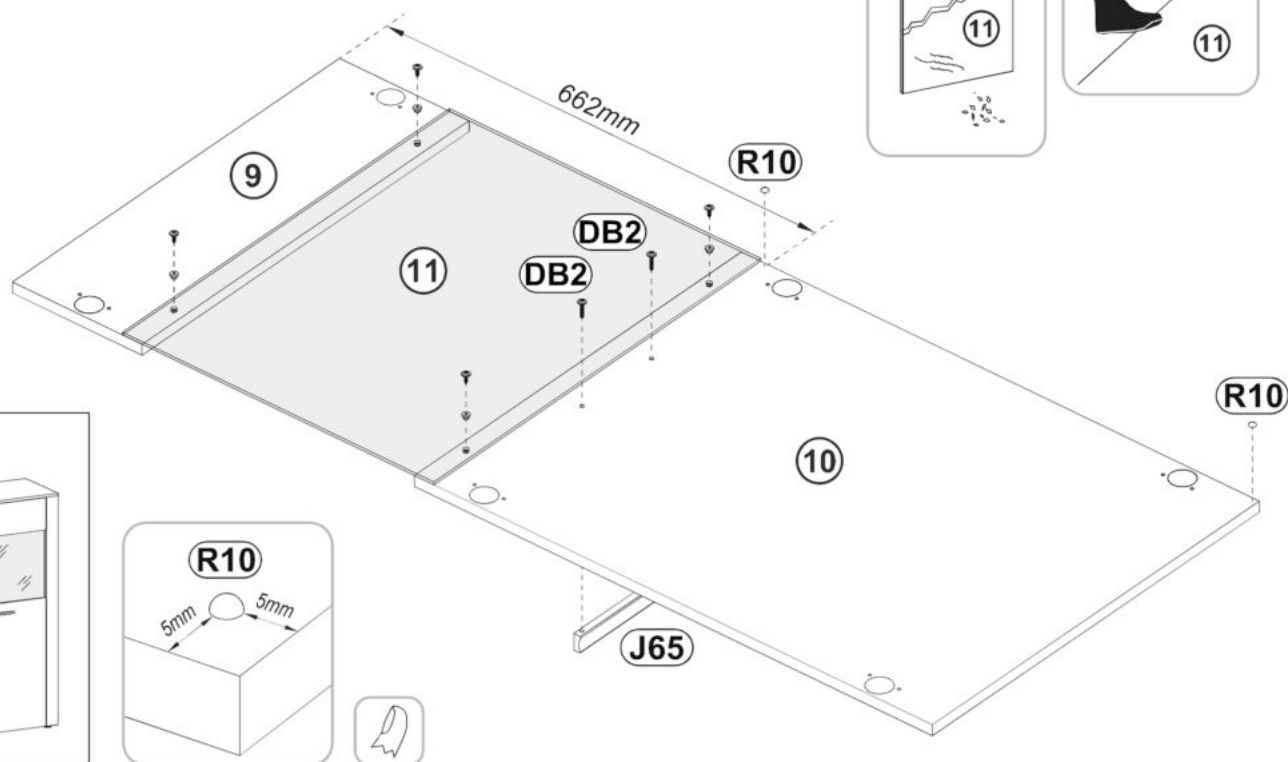
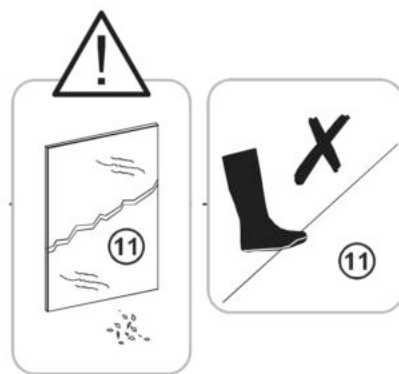
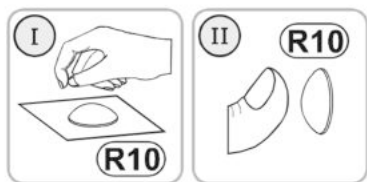
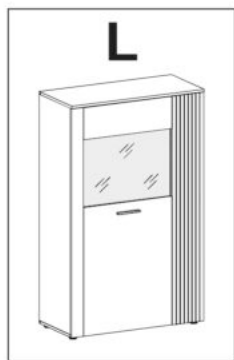
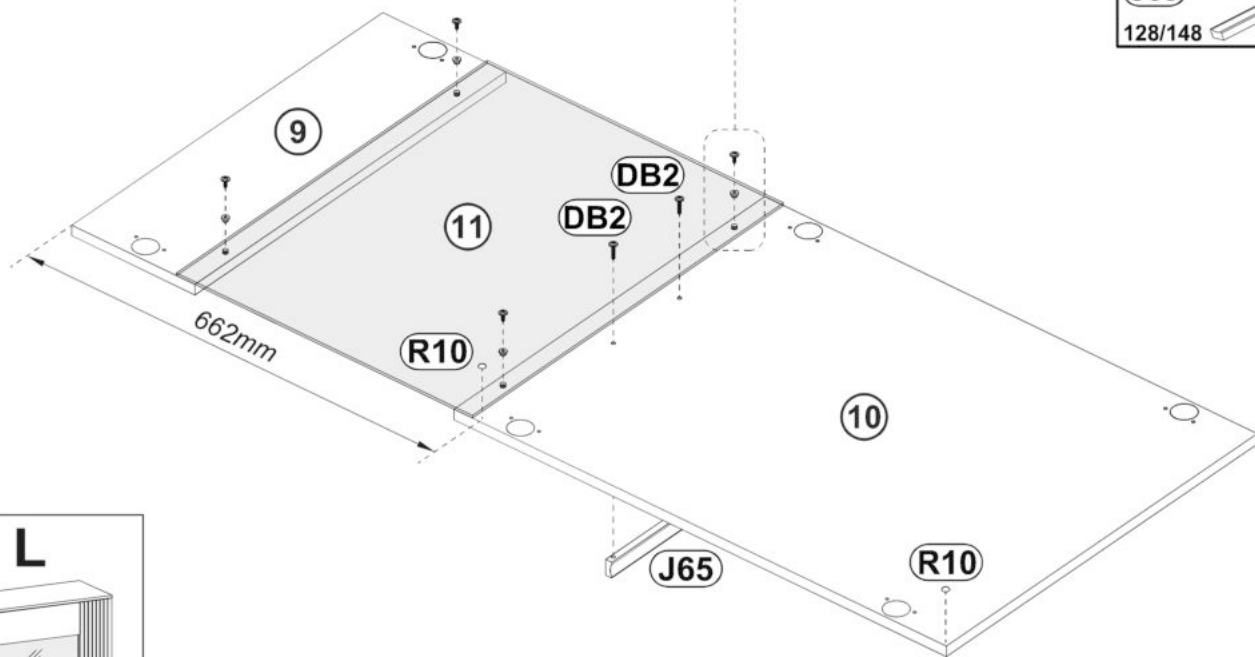

(N5) 10x6x10		x4
(DA21) 4,2x16		x4
(R10) Ø10		x2
(DB2) 4x25		x2
(J65) 128/148		x1

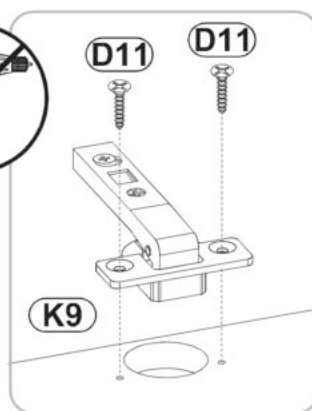
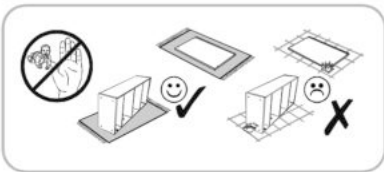

13



K9  x3
Ø35

D11  x6
3,5x16

O6  x3
40x40x14

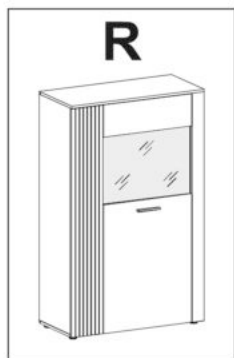
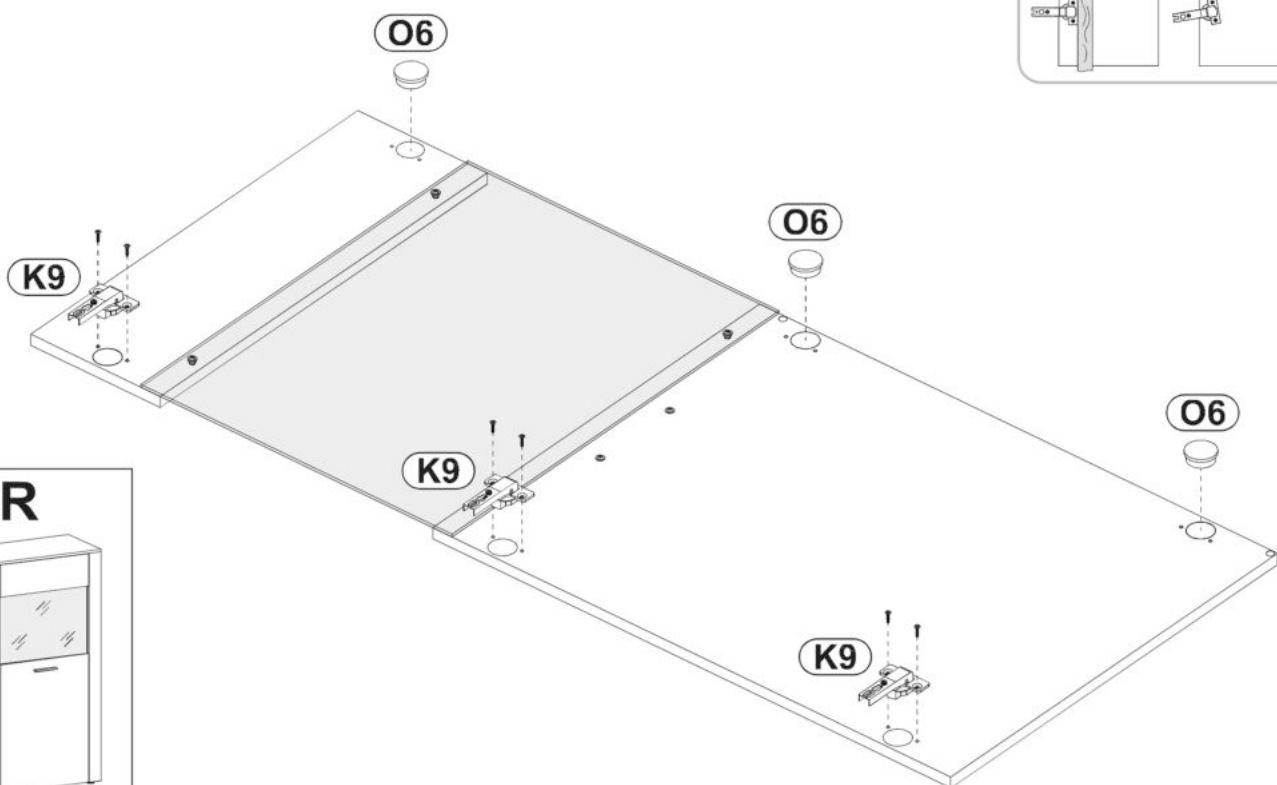
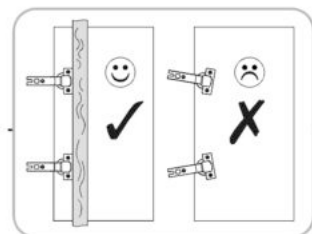
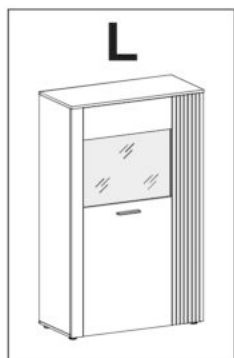
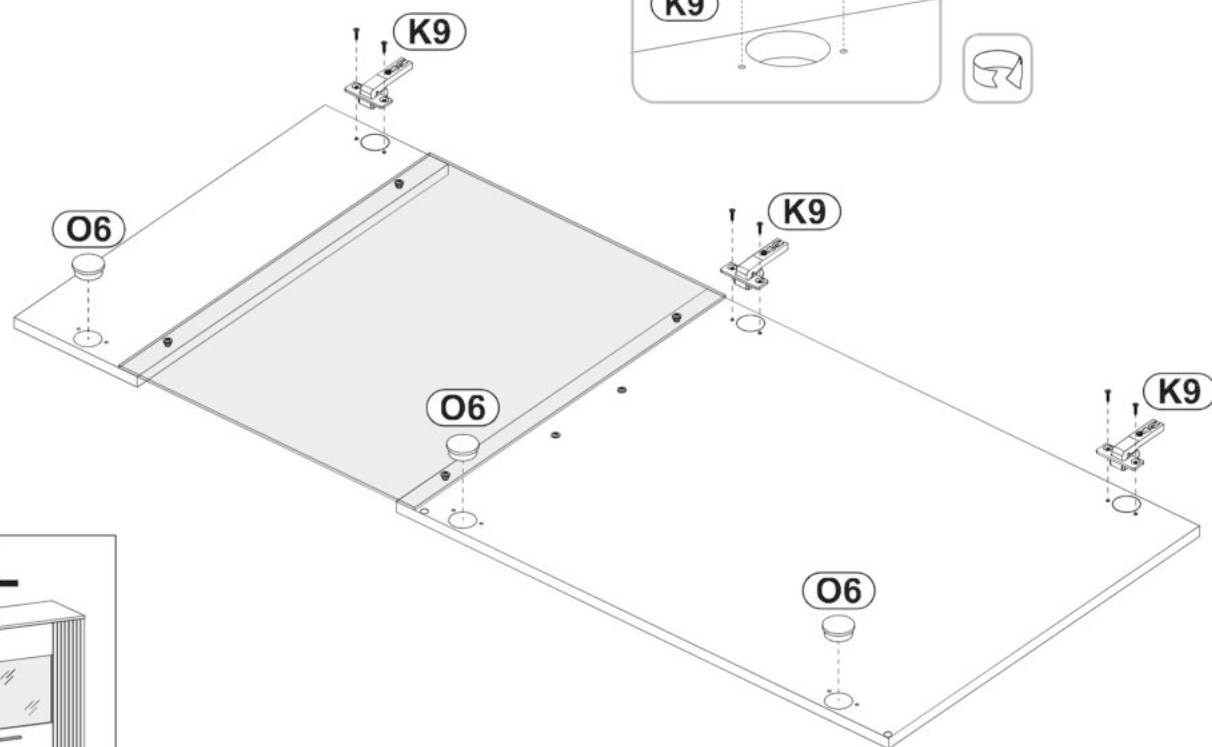

14

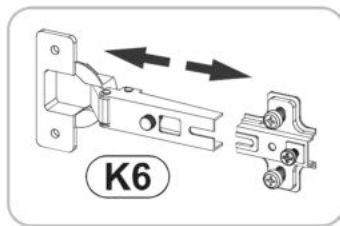
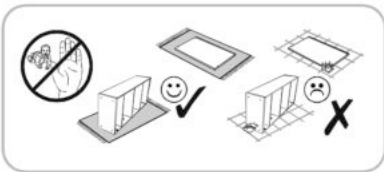

K6
Ø35  x3

DA21
4,2x16  x6

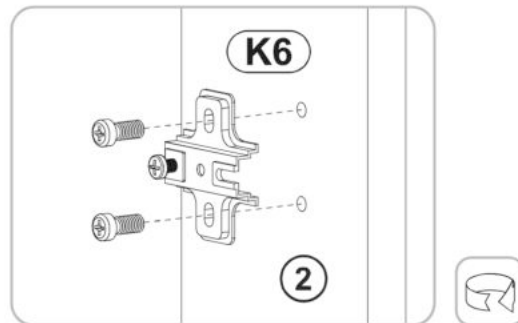
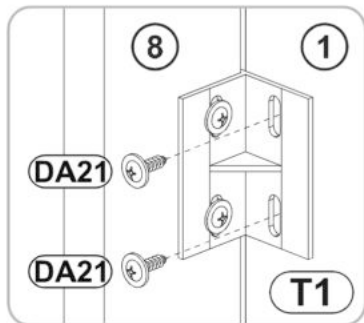
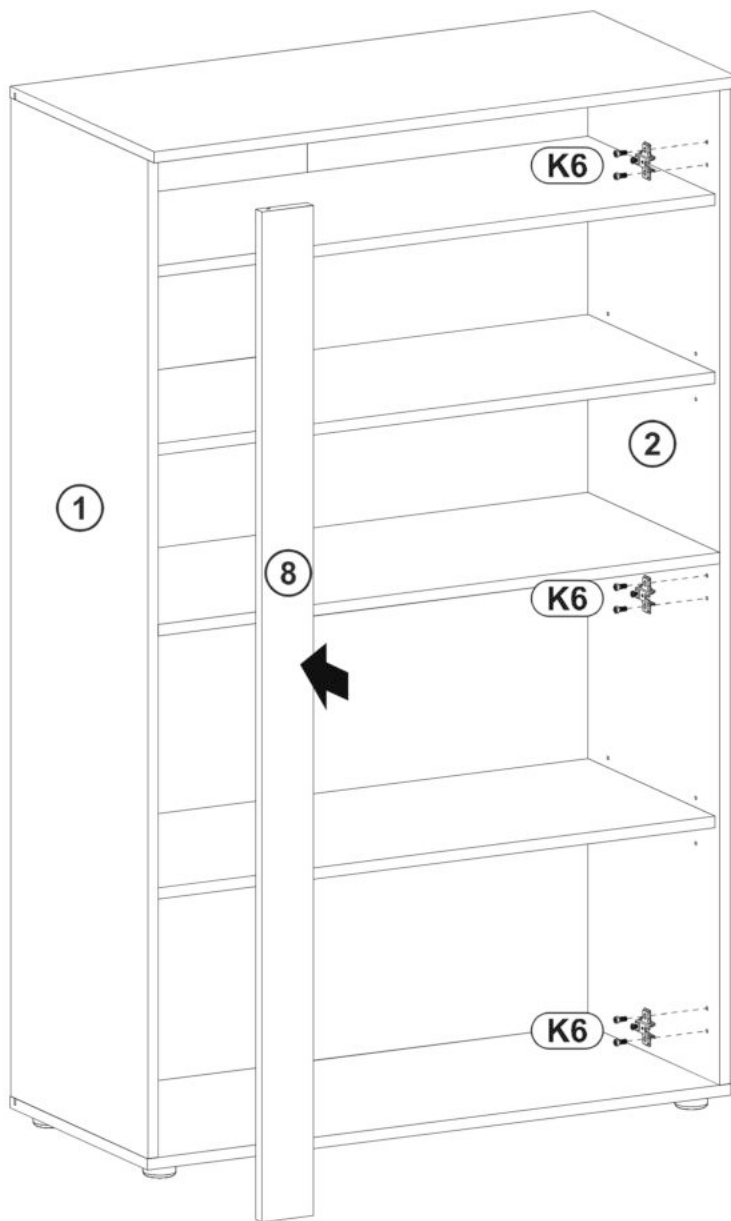
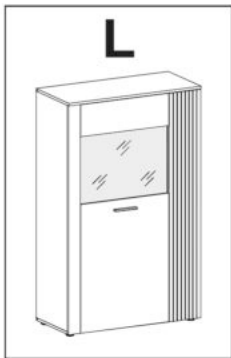

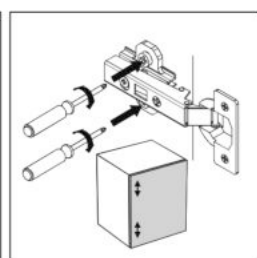
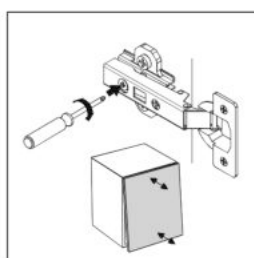
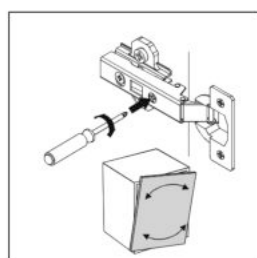
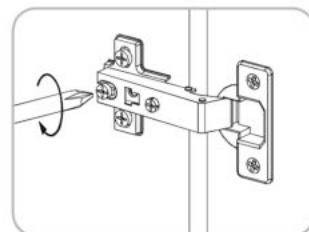
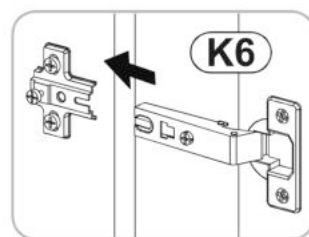
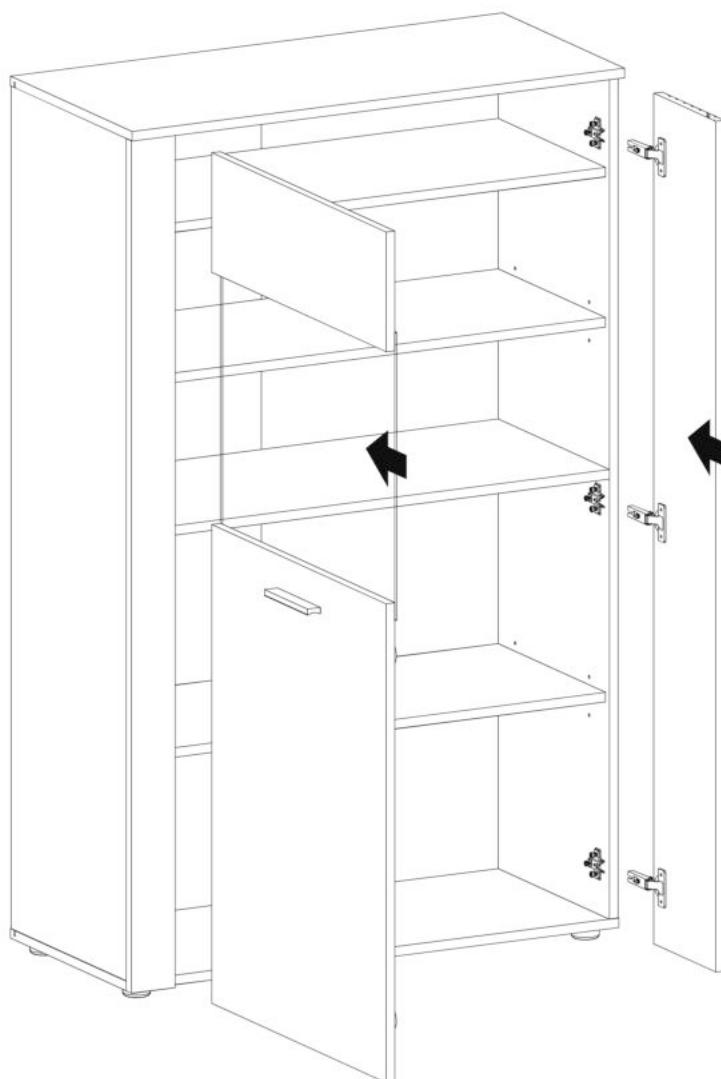
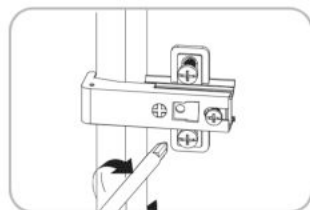
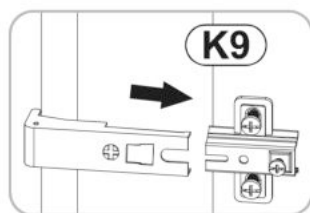
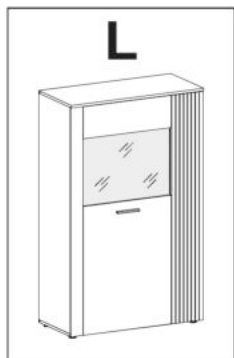
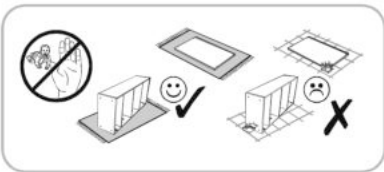

16

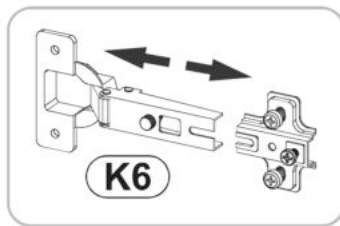
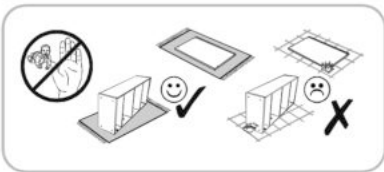

K6
Ø35  x3

DA21
4,2x16  x6

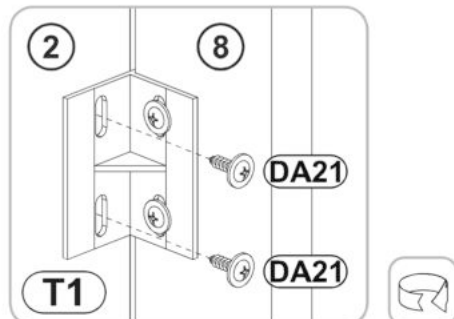
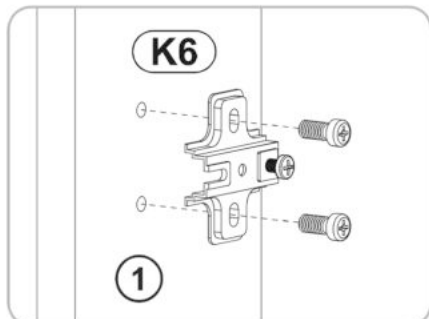
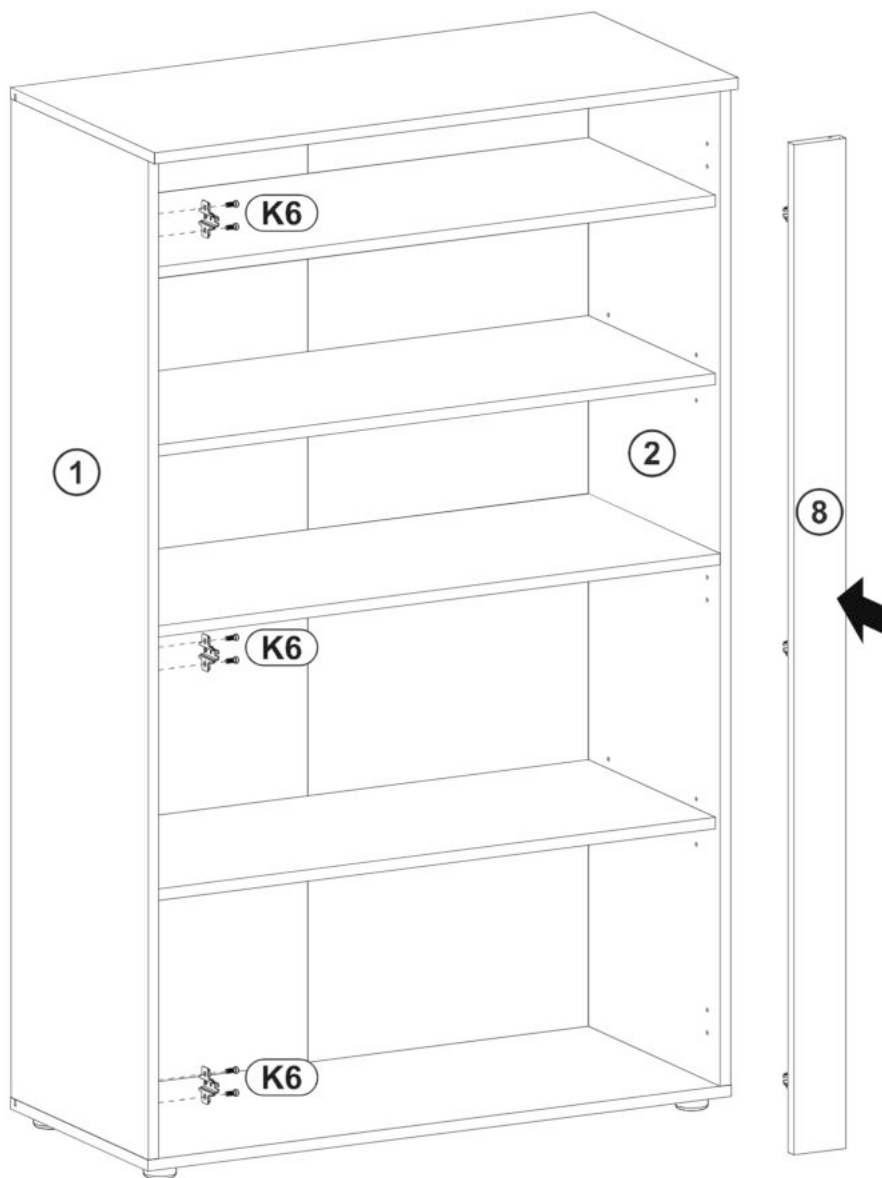

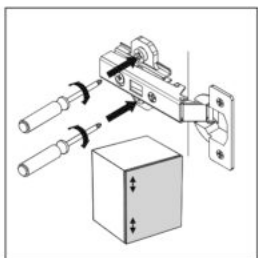
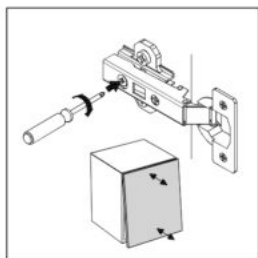
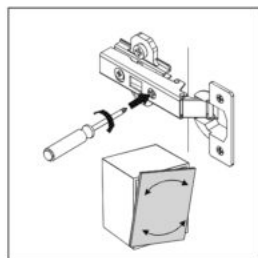
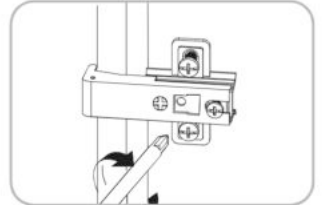
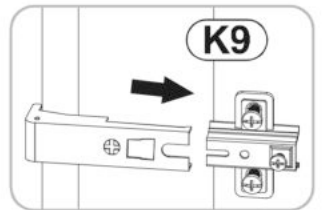
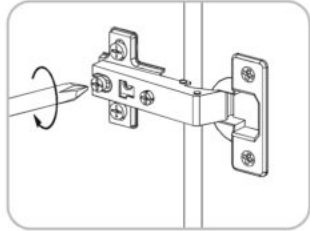
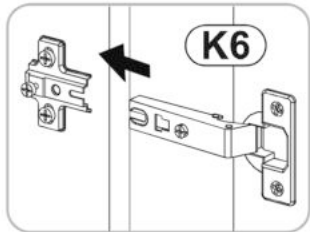
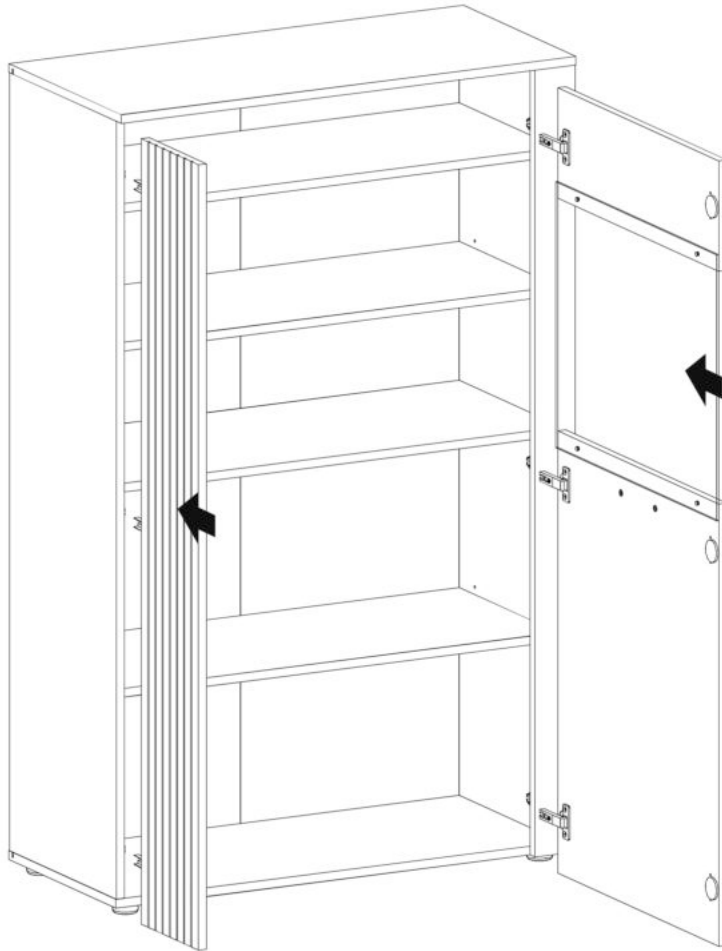
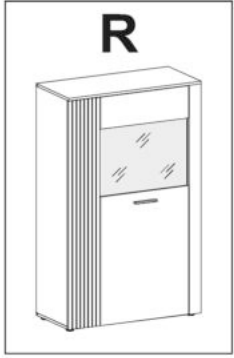
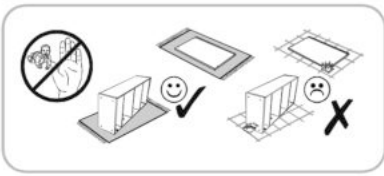



L

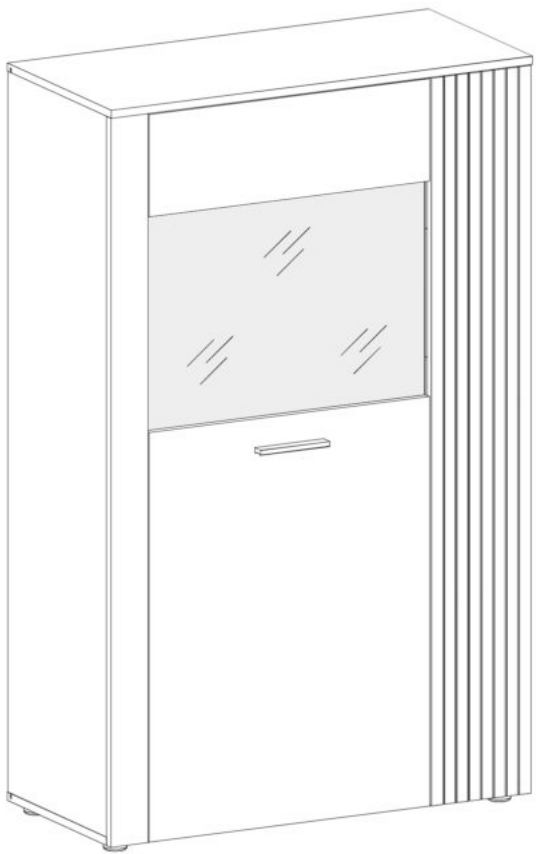

R

